

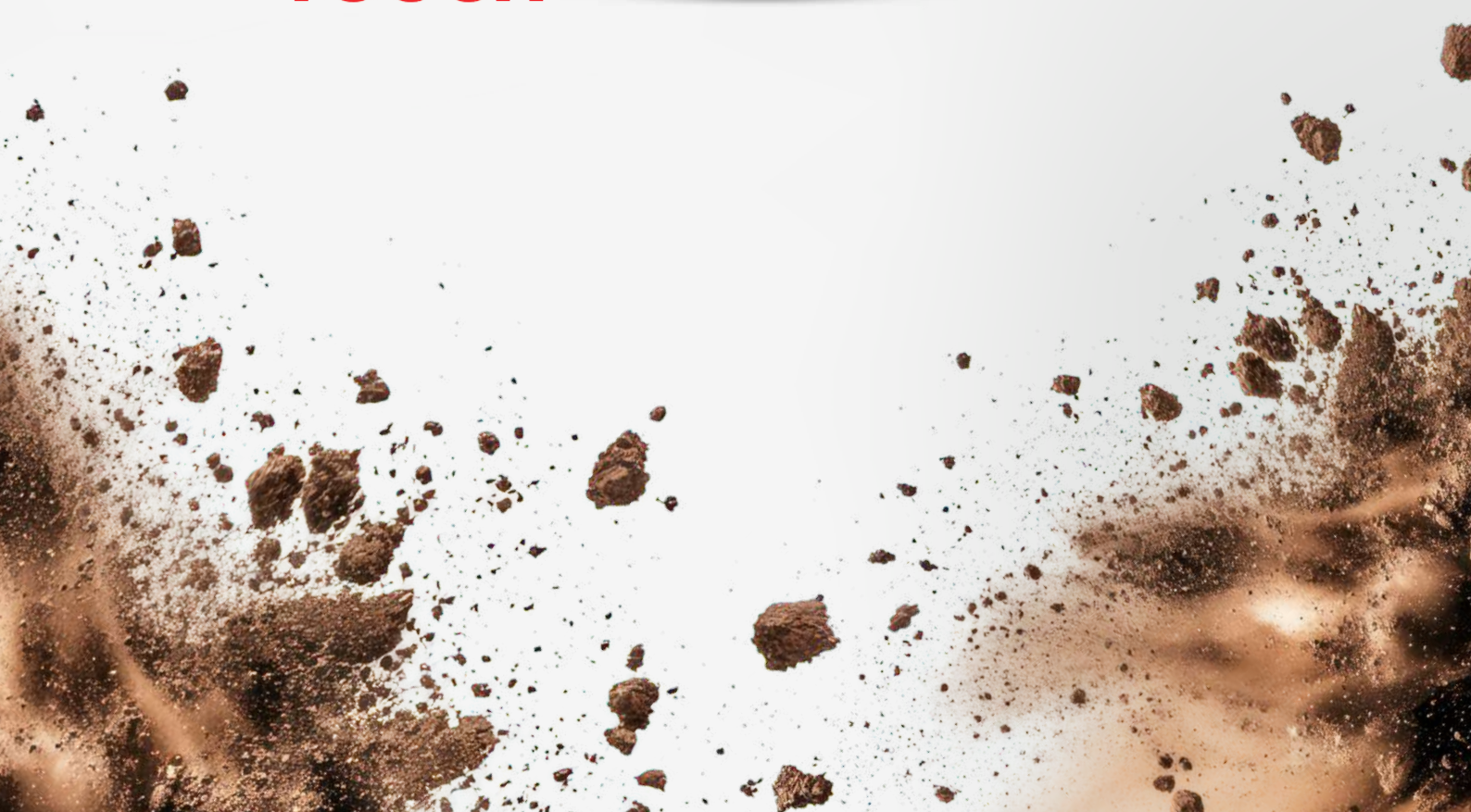

Boost your
Excavator



TOUCH



iDig is the leader in 2D Excavator Machine Control with wireless sensors

iDig develops cutting-edge wireless excavator machine control systems powered by solar-charged sensors. Our solutions empower both owner-operators and major industry players to work smarter, not harder.



Wireless

A wireless system with sensors that communicate via Radio Frequency, powered by solar-rechargeable batteries, enabling fast installation without the need for welding or cables to any machine.



Multi-Machine

Requiring just a set of sensor plates, equip additional excavators for very little cost. Switch from machine to machine in minutes.



Intuitive

An intuitive system that is quick to install, simple to calibrate, and easy to use without extensive training.



Safety

iDig lets you work autonomously, eliminating a grade checker or the need to leave your machine to check grade, boosting efficiency and reducing accident risks.



Cost-Effective

Enjoy a quick return on investment with a simple, efficient tool that offers exceptional value. iDig pays for itself in under a year.



Control Box

Powerful and robust 7" tablet with patented software.

Compatible Attachments

Customize your iDig according to your machine configuration.



Knuckle boom

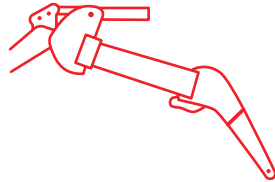

Double Deported Arm

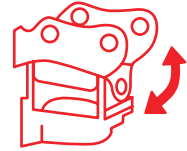

Bucket or Tilt attachment

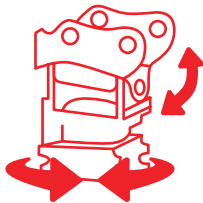

Tilt rotator

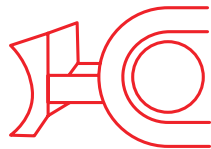

Front Dozer Blade

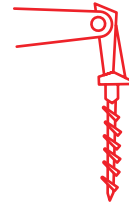

Auger - Clamshell

LED Bargraph

An in-cab assistant, positioned within your field of vision, helping you position your bucket with precision. The color coded LEDs guide you to achieve your desired measurements.

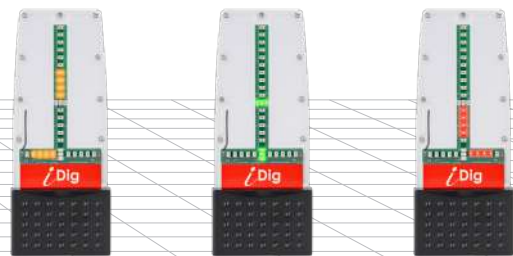

Depth, Distance & Slope

Control everything from your cab

Maximize efficiency with TOUCH 2D. Dig to your desired depth and/or slope with ease, and measure distances directly with your bucket. The height alarm keeps you working safely, even in confined areas.

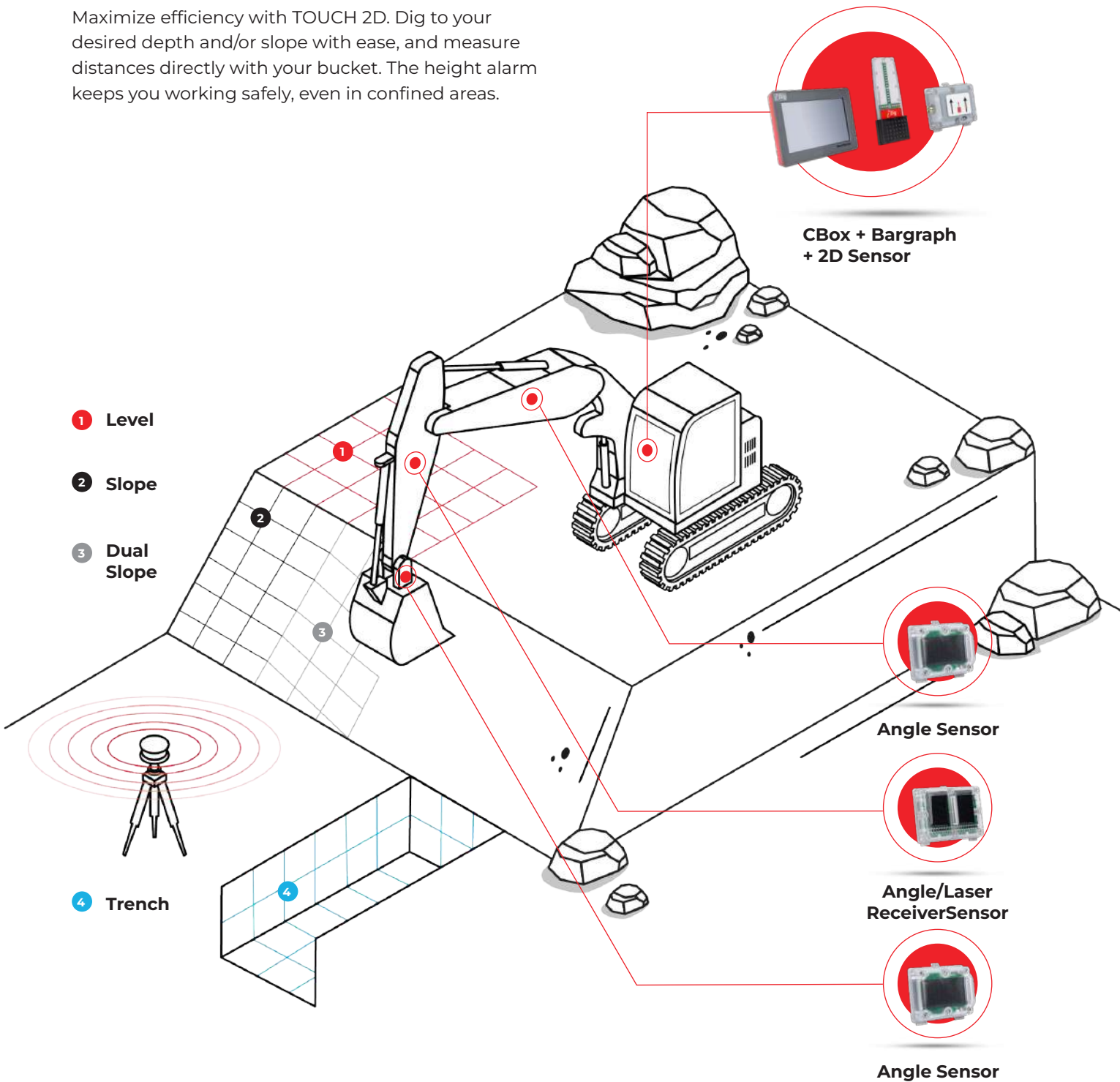

Applications

LANDSCAPING | FOUNDATIONS | ROAD & UTILITY NETWORKS | URBAN PLANNING | DRAINAGE | GREEN AREAS | SWIMMING POOLS

TOUCH 2D «The original»

Stay in Control Right from Your Cab.

Set your target slope, depth, or distance using the in-cab screen and follow our intuitive LED indicators to reach your target with precision. No need for manual grade checks or relying on a grade checker in trenches.

Package Composition

- 1 TOUCH 2D software
- 1 Control box
- 1 LED bargraph
- 2 Mini Angle Sensors with mounting plates
- 1 Angle/Laser Receiver Sensor with a mounting plate
- 1 Mini Chassis Sensor with a mounting plate
- 3 quick-connect cables, including 'cigarette lighter' 12/24V power cable

Specifications

Power Supply	Solar Rechargeable Battery
Sensors	Waterproof Sensor - IP67 From 55x75x25mm to 70x100x25mm
Memory	100 machines each with 100 buckets
Accuracy	+/- 3/8 inch
Operating temperature	(-4°F - 158°F)
CBox Screen Size & Resolution	7' & 800x480px



	TOUCH 2D
Grade Control for horizontal, single or dual sloped areas	✓
Tilt bucket	✓
Cab rotation	✓
Mono & Knuckle boom	✓
Multi-machine	✓
Laser alignment	✓
Rotary attachment	✓
Blade guidance	✓
Clamshell & Auger	✓
Advanced 2D mode	✓
Distance measurement	✓
Height alarm	✓
UR Option for Double Offset Boom	✓
Underwater mode (± 6 feet)	✓
Tape Measure Mode	✓

| Accessories

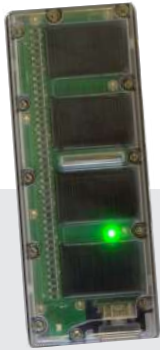

Big Angle/Laser Sensor

The perfect tool for receiving laser signals and guiding your cutting edge with accuracy.



Extra Machine Kit

Transfer your iDig system between machines in just minutes. This convenient kit makes it easy to switch between pre-equipped machines and helps maximize fleet productivity with one TOUCH 2D system.



Tilt Sensors

Precisely control bucket tilt using your TOUCH 2D system for accurate and efficient grading.



21 boulevard Littré
78600 Le Mesnil Le Roi, France

www.idig-system.com



www.idig-system.com

Distributor/Dealer Stamp



iDig is a BRIDGIN company. BRIDGIN is a limited liability company with a share capital of €1,100,000, registered with the Versailles Trade and Companies Register under number B 438 880 486. Head office: 21 boulevard Littré, 78600 Le Mesnil-le-Roi. Phone: 09 73 87 04 24

Images are non-contractual and provided for illustrative purposes only.